

BP-60 Spin Pull Spin Ultra™

Air Hydraulic Rivet Nut Tool

Operating Instructions

Maintenance

Notices



Index

<i>Operating Instructions.....</i>	<i>Page 1</i>
<i>Mandrel Change Instructions.....</i>	<i>Page 1</i>
<i>Stroke Adjustment.....</i>	<i>Page 1,2</i>
<i>Technical Data and Tool Breakdown.....</i>	<i>Page 3</i>
<i>Spare Parts List.....</i>	<i>Page 4</i>
<i>Topping Off the Oil.....</i>	<i>Page 5</i>
<i>Important Safegaurds.....</i>	<i>Page 6,7</i>
<i>Warranty Information.....</i>	<i>Page 8</i>

BP-60 SPIN-PULL-SPIN ULTRA

AIR/HYDRAULIC RIVET NUT TOOL

Operating Instructions

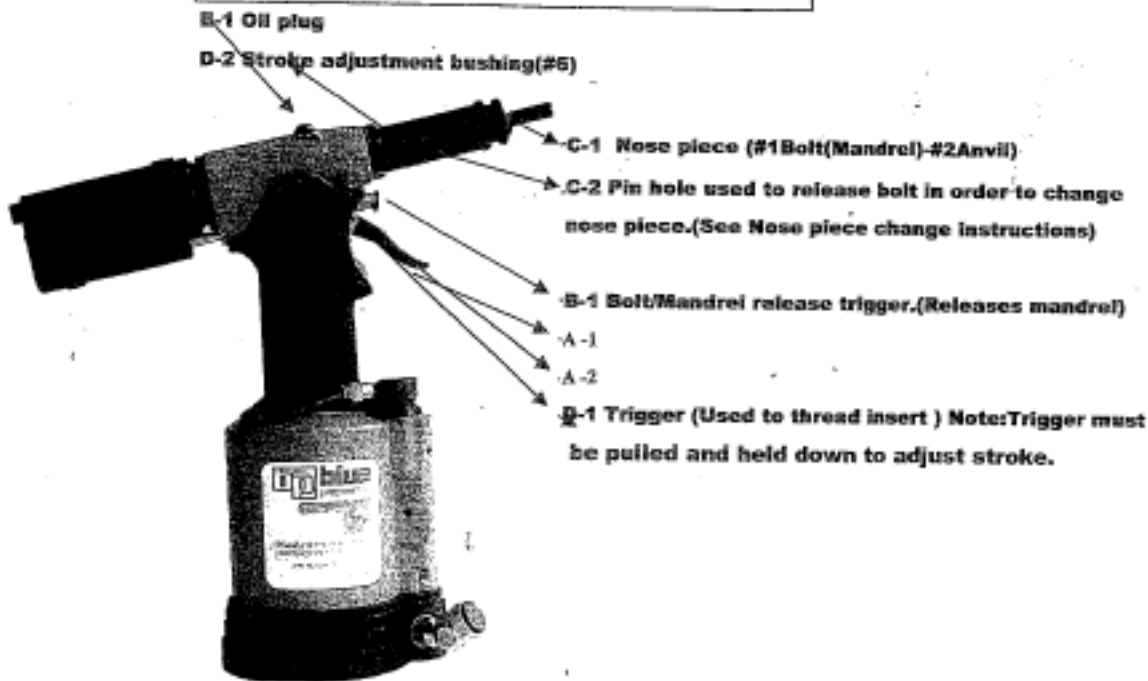

Operating Instructions:

A-1 Lightly press A-1(#110) with middle finger(1/2 down). This will thread the insert onto the mandrel(

A-2 Press A-1 to place fastener in the workpiece(1/2 half of trigger pull will complete installation).

B-1 Press B-1(#103) to release(spin) the mandrel off or the insert.

Change nose piece:

C-1 Loosen nut(#3) and remove anvil(#2).

C-2 Insert pin <supplied>(#120) through small hole in nose assembly(#4)

and through spring pin (#8).Pull the pin toward the tool to release the Mandrel (#1).

Reverse process when you install new mandrel(you should hear a click when mandrel is locked in).

Stroke adjustment Instructions : (Note: To avoid breaking mandrels, stroke must be adjusted!)

D-1 Must push down trigger (#110)to adjust stroke(connected to compressed air).

D-2 Adjust stroke by turning stroke adjustment bushing(#6)and (#4) to fine tune adjustment to work for the insert being used.---Adjustment range is 0-7mm.(Max 7mm)

When adjusting the stroke of the tool, set the BP-60 tool at 0 stroke.

Observe the + and - on the tool nose (part#4). This indicates the direction to turn the adjustment bushing. (+) symbol indicates direction to turn bushing toward maximum stroke, while the (-) symbol indicates direction toward minimum stroke.

Start at 60 psi. and increase accordingly.

Stroke Adjustment Instructions (cont.)

Note:

(DO NOT OPERATE TOOL ABOVE 100 lbs. PSI)

90 lbs. is optimal for most applications and will aid in prolonging tool life.

Note: This tool possesses power that can damage some internal components when operated over recommended air pressures.

***To avoid mandrel breakage. Use the lowest possible air pressure when installing inserts between 8-32 and 1/4-20**

(*Two-2)

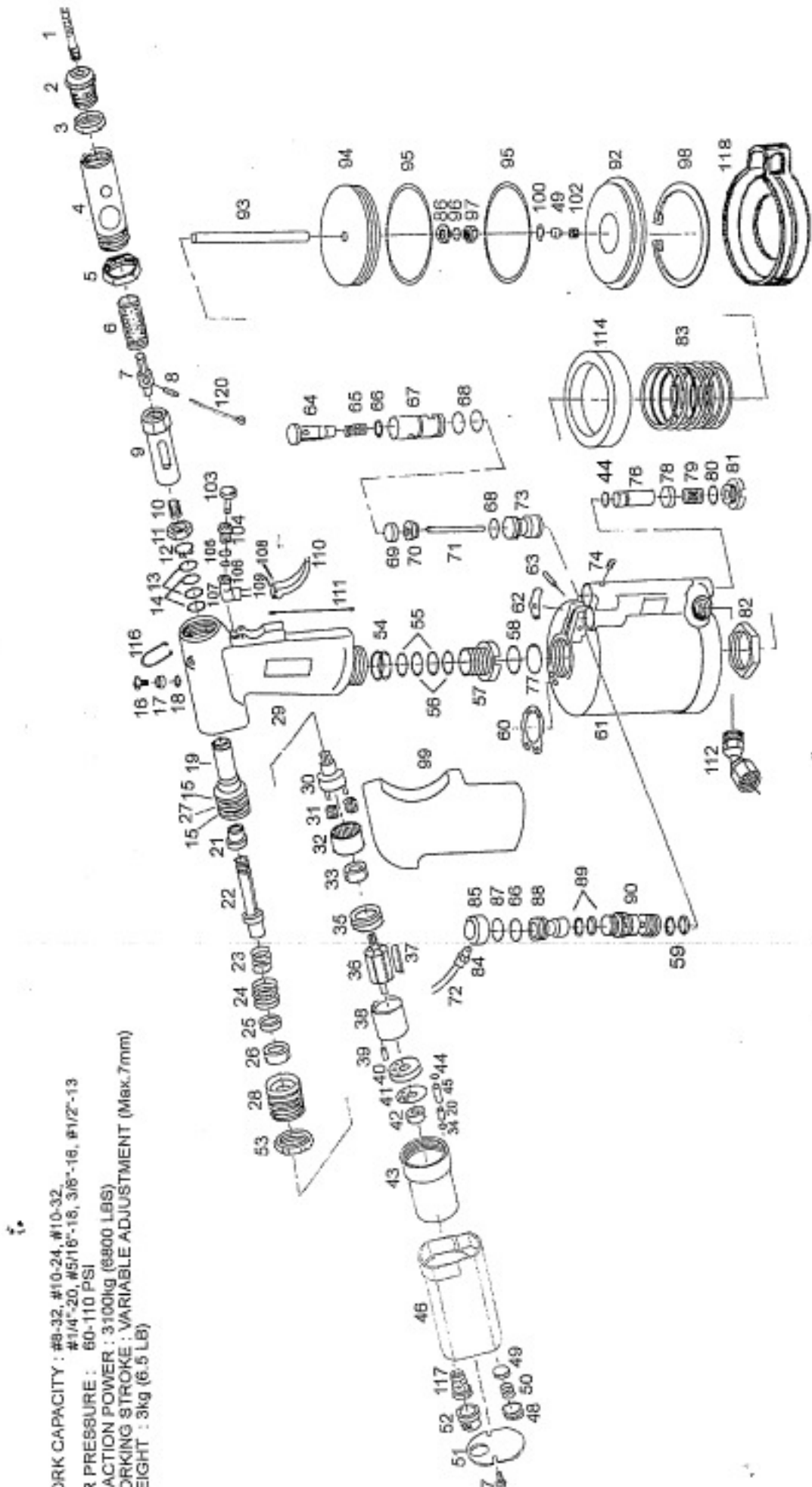

WORK CAPACITY : #8-32, #10-24, #10-32,
 AIR PRESSURE : #1/4"-20, #5/16"-18, 3/8"-18, #1/2"-13
 REACTION POWER : 3100kg (6800 LBS)
 WORKING STROKE : VARIABLE ADJUSTMENT (Max.7mm)
 WEIGHT : 3kg (6.5 LB)

INDEX NO.	PART NO.	DESCRIPTION	Q'TY	INDEX NO.	PART NO.	DESCRIPTION	Q'TY
1	838-16	Bolt 3/8"-16	1	67	600022	Valve Bushing	1
2	60-3816	Nut Anvil #3/8	1	68	10445	O-Ring	3
3	600021	Nut	1	69	10442	Valve Plate	1
4	6000060	Head	1	70	600027	Valve Plate Washer	1
5	600016	Nut	1	71	600040	Pin	1
6	600013	Adjustable Bushing	1	72	600072	Tube	1
7	600007	Hexagon Bit	1	73	600026B	Low Valve Bushing	1
8	600041	Spring Pin	1	74	600074	Screw M4	1
9	6000082	Bolt Bushing	1	76	600029	Low Valve Rod	1
10	600076	Spring	1	77	02170	O-Ring	1
11	600009	Nut	1	78	11542	Valve Plate	1
12	600042	Snap Ring	1	79	10544	Spring	1
13	11502	Ring Washer	2	80	25203	O-Ring	1
14	11554	X-Ring Seal	2	81	10550	Plug Screw	1
15	11501	O-Ring	2	82	02121	Lock Nut	1
16	02171	Oil Plug	1	83	600046	Spring	1
17	400017A	Fill Washer	1	84	51058	Tube Connector	1
18	02197	O-Ring Seal	1	85	600085	Valve Cap	1
19	600012	Hydraulic Plunger	1	86	48047	Washer	2
20	6000631	Valve Rod	2	87	R123X24	O-Ring	1
21	600020	Bushing	1	88	600084	Valve Stem	1
22	600011	Shaft	1	89	R9X15	O-Ring	2
23	600015	Spring	1	90	600083	Valve Bush	1
24	600045	Spring	1	92	500035	Air Cylinder Cap	1
25	600054	Washer Nut	1	93	600019	Plunger Rod	1
26	66000	Ball Bearing	1	94	500023	Piston Disc	1
27	11549	Washer	1	95	11531	O-Ring Seal	2
28	600051	Screw Bushing	1	96	48045	Washer	1
29	600002	Hydraulic Section	1	97	48048	Nut	1
30	600052	Gear Spinder	1	98	11514	Clip	1
31	600031	Gear	3	99	600099	Hand Grip	1
32	600043	Ring Gear	1	100	19314	Retaining Ring	1
33	6608	Ball Bearing	1	102	19313	Spring	1
34	R06X15	O-Ring	2	103	600067	Bottom	1
35	600055	Front Plate	1	104	600066	Screw Bush	1
36	82507	Rotor	1	105	10748	O-Ring Seal	1
37	82115	Blade	4	106	R2X1	O-Ring	1
38	85209	Cylinder	1	107	600070	Adaptor	1
39	25006	Pin	1	108	02169	Pin	1
40	85230	End Plate	1	109	02168H	Pin	1
41	23211	Motor Gasket	1	110	02138	Trigger	1
42	25004	Ball Bearing	1	111	600033	Trigger Rod	1
43	600061	Motor Housing	1	112	T1020S	Universal Joint	1
44	11560	O-Ring Seal	3	114	11530	Damping Ring	1
45	600048	Tube	2	117	600096	Muffler Bush	1
46	600063	Valve Seat	1	118	11570	Rubber Cushion	1
47	600047	Screw	2	*** Accessories ***			
48	600071	Screw Bushing	2	1	B12-13	Bolt 1/2"-13	1
49	19312	Rubber plate	3	1	B516-18	Bolt 5/16"-18	1
50	23208	Valve Spring	2	1	B14-20	Bolt 1/4"-20	1
51	600064	Valve Plate	1	1	B10N24	Bolt 10-24	1
52	600065	Exhaust Cap	1	1	B10N32	Bolt 10-32	1
53	600058	Nut	1	1	B8N32	Bolt 8-32	1
54	02116	O-Ring Seal	2	2	60-1213	Nut Anvil 1/2"	1
55	10554	O-Ring Seal	2	2	60-515	Nut Anvil 5/16"	1
56	10556	Washer	2	2	60-1420	Nut Anvil 1/4"	1
57	600018	Screw Plug	1	2	60N10	Nut Anvil #10	2
58	25022	O-Ring	1	2	60N8	Nut Anvil #8	1
59	R10X1	O-Ring	2	3	600021	Nut	5
60	600032	Gasket	1	116	54059	Hanging Ring	1
61	600001	Air Cylinder	1	120	600069	Pin	1
62	500034	Trigger Lever	1	*	W24	Wrench 24/27mm	1
63	02167	Pin	1	*	54005	Hex. Wrench	1
64	600023	Valve Rod	1	*	11780	Oil Syringe	1
65	10441	Spring	1				
66	10546	O-ring	2				

Topping off the oil

The oil should be topped off periodically. Top off oil when there is a noticeable loss of power.

To top off the oil:

Disconnect the tool from the compressed air source. Stand tool upright. Remove the Oil plug (E-1) at top of tool with the included allen wrench. Fill the included oiling syringe about half way with 30grade hydraulic fluid(or equivalent). Screw the oil syringe part (#11790) onto the oiling port at the top of the tool. The syringe should be screwed on firmly, just beyond hand tightening to ensure air seal. Using the plunger on the syringe, firmly press the oil into the tool. Press firmly, noticing the air bubbles. When air bubbles stop, the tool is filled. Finally, remove the oil syringe and replace the oil screw plug.



Warning! The fore mentioned operation must be preformed while tool is disconnected from pressurized air source.

IMPORTANT SAFEGUARDS --

READ THIS INSTRUCTION MANUAL CAREFULLY AND FULLY UNDERSTAND ALL THE INFORMATION PROVIDED PRIOR TO USING THIS TOOL.

(page 1 of 2)

- Always inspect, maintain, and operate this tool in accordance with American National Standards Institute (ANSI) Standard B186.1 (Safety Code for Portable Air Tools), and any other applicable codes or standards regarding the safe operation of compressed air tools.
- In order to provide maximum tool life, performance, and safety, operate this tool at 100psi or recommended air pressure, using dry air and a 3/8" / 9.5 mm hose. Always lubricate the tool per the manufacturer's specifications prior to operation, or use an inline oiler with proper filtration.



- Always wear impact-resistant eye and / or face protection when operating or servicing this tool. Visitor's spectacles or home-grade safety glasses are not adequate for power tool applications.



- Always use hearing protection approved by OSHA or NIOSH. Lack of proper protective gear in high-noise environments can lead to permanent loss of hearing.

- Always keep the tool in utmost operating condition. Lubricate and wipe down the tool after each use. Inspect for leaks, damage to the body, or binding and/or broken moving parts.

- Air under pressure can cause severe injury, or possibly death, if care is not taken when using compressors, air tools, air reservoirs, and pneumatic plumbing.

- Always turn off the air supply, drain water from the air line, and detach the tool from the air supply prior to removing, installing, or adjusting any part of this tool. Inspect for frayed hose ends and damaged fittings. Replace any damaged items immediately. Do not use quick-detach couplings at the tool – see

operating instructions for correct setup. NEVER carry the tool by the hose.

- Slips or falls while operating air tools can result in serious injury or death.



Keep excess hose away from walkways and working areas.

- Air tools can vibrate during use. Vibration and repetitive motions over extended periods of time can cause injury to hands, joints, neck, and back. Immediately stop using the tool if discomfort or pain occurs. Consult a medical professional before resuming tool use.

- Always place the tool on the workpiece prior to starting the tool. Keep body stance balanced and firm while operating the tool – do not overreach.

- Keep away from the rotating end of the tool. Do not wear jewelry or loose clothing. Secure long hair and beards away from the work area. Do not wear pendant neckwear of any kind while operating rotating equipment.

- Tool shaft may continue to spin after the trigger is released. Avoid direct contact with tool end accessories during use. If using gloves for cushioning or heat protection, USE EXTREME CAUTION. Gloves can bind with moving parts and result in injury or amputation.

- Do not lubricate the tool with flammable fluids such as kerosene, diesel, jet fuel, or aromatic spirits.

**(Important Safeguards continued. page
2of2)**

- Do not force the tool to operate beyond its rated capacity.
- Do not remove any labels, tags, or warning stickers. Replace any damaged labels prior to putting the tool in service.

LIMITED WARRANTY

Blue Pneumatic brand tools are warranted to be free from defects in materials and workmanship. Tools thought to be defective should be returned to the factory or an authorized service center or authorized distributor, where it will be examined for repair and or replacement.

This warranty does not cover damage to tools that arise from abuse, alteration or the tool being used for anything other than its intended use. Repair and replacement will not apply in the previously stated circumstances.

The duration of the warranty and any other warranty including, but not limited to, any implied warranty of merchantability is expressly limited to one year beginning from the date of delivery to the original user. The obligation of Blue Pneumatic brand tool distributors under any warranty, express or implied, is limited solely to repair or replacement from its distributor network or factory.